

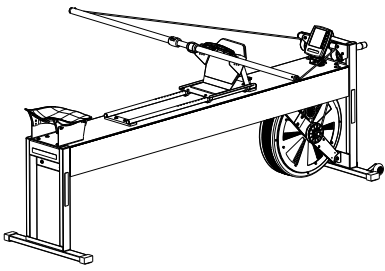

# KayakPro® Xeon 2.0 Kayak Ergometer

## ASSEMBLY MANUAL v 2.0



KP-A-00250 REV 02

KayakPro® Xeon 2.0 Kayak Ergometer

### USAGE SAFETY PRECAUTIONS

#### SAFETY PRECAUTIONS

Safe operation and use.

Serious injury can occur if the following precautions are not observed.

1. Always consult your physician prior to undertaking any exercise regimen.
2. Keep head, limbs, fingers, and hair clear of all moving parts and flywheel cage.

Please note for the KayakPro® Xeon Kayak Ergometer, the space requirements are:

machine storage: 2.1m (l) x 0.8m (h) x 0.6m (w)  
6' 11" (l) x 2' 8" (h) x 1' 10" (w)

safe working area: 3m (l) x 1.8m (h) x 1.75m (w)  
9' 10" (l) x 5' 11" (h) x 5' 9" (w)

3. Inspect machine prior to use. Do not use the machine if it appears damaged or inoperable.
4. Contact manufacturer if machine is broken or jammed.
5. Use machine only as intended.
6. Do not modify the machine.
7. Children must not be allowed near this machine.
8. Teenagers must be supervised in the use of this machine.
9. By using the KayakPro® Xeon Kayak Ergometer the user accepts all and full responsibility for self.

### GENERAL General Notes

Tools required:

- 4mm Hex Allen Key
- 5mm Hex Allen Key
- 6mm Hex Allen Key
- Side Cutters (for Cable Tie)

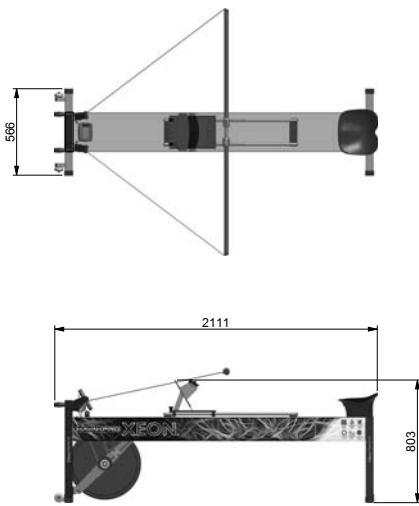

### STEP 2 Attach Front Foot & Foot Assemblies to Front Leg Assembly

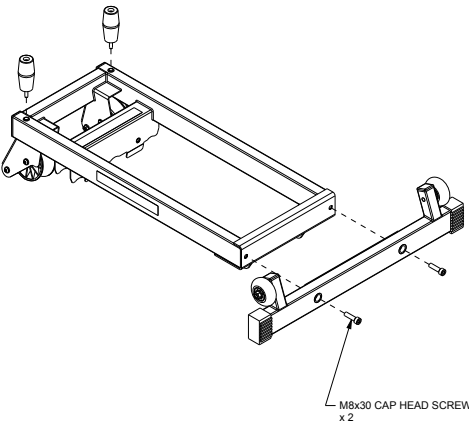

### STEP 6 Fit Seat Platform & Seat

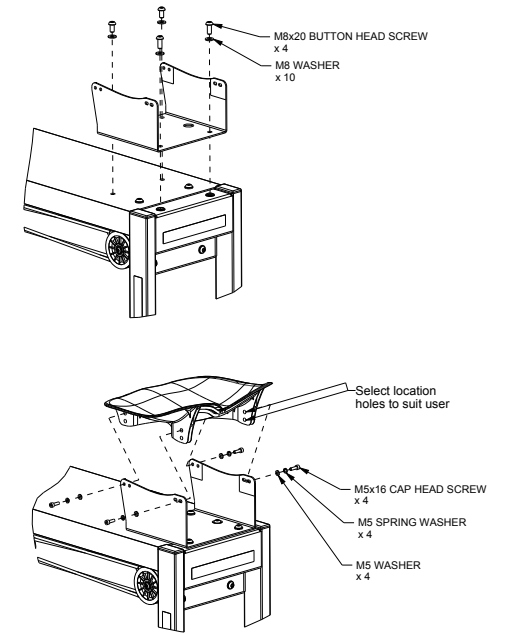

### STEP 3 Fit Bearing Blocks & Pull Bar to Footrest Assembly

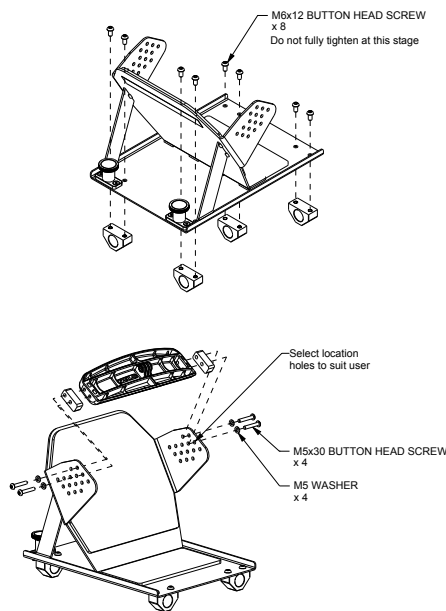

### STEP 7 Fit Front Leg to Beam

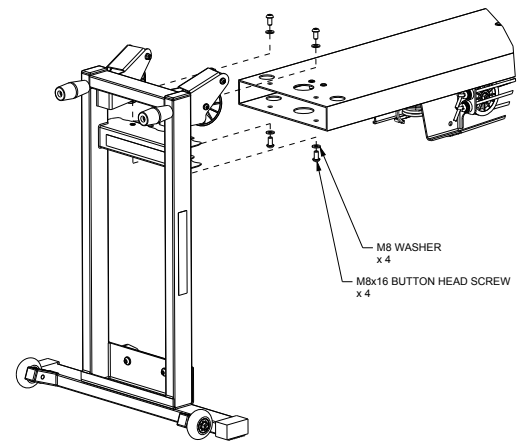

### STEP 4 Assemble Footrest Rails

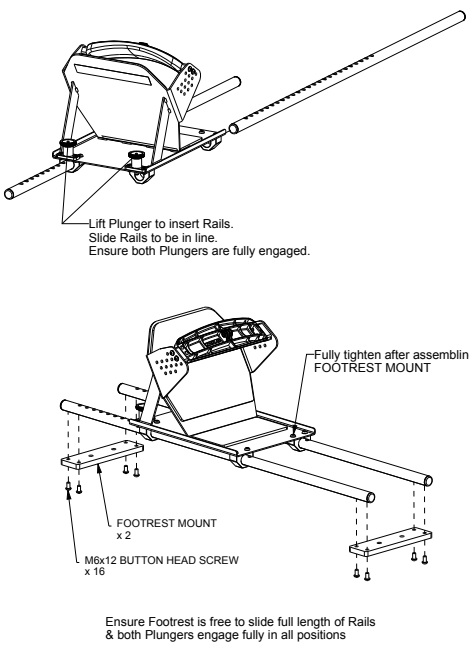

### STEP 8 Fit Footrest & Rails to Beam Assembly

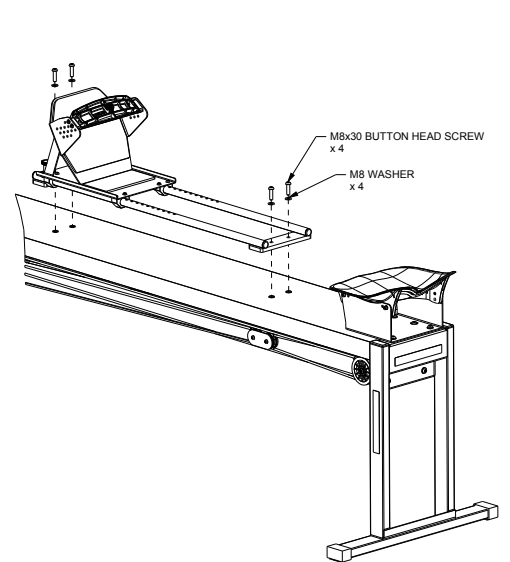

### STEP 1 Attach Rear Foot to Rear Leg Assembly

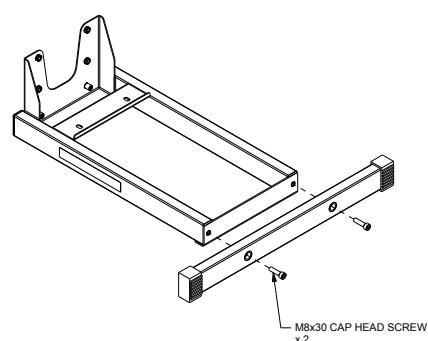

### STEP 5 step description

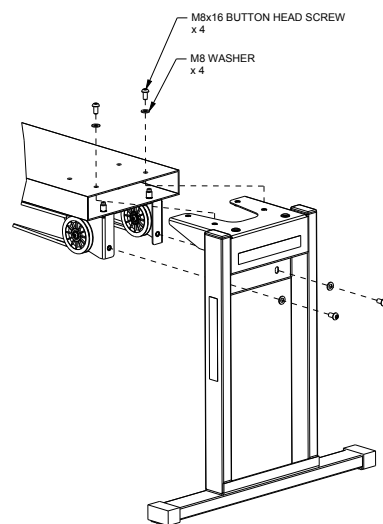

### STEP 9 Fit Console

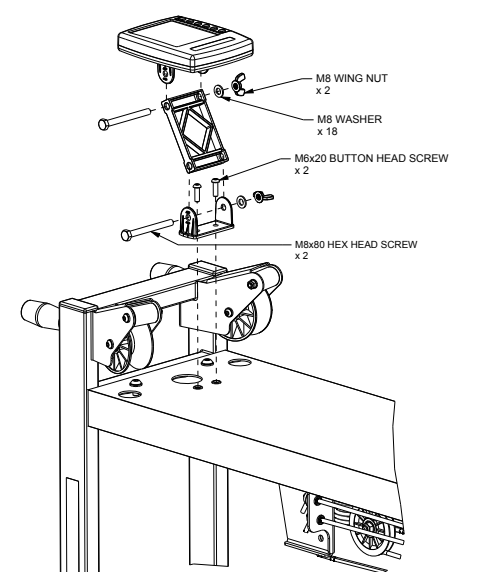

STEP 10 Thread Rope Through Beam Assembly

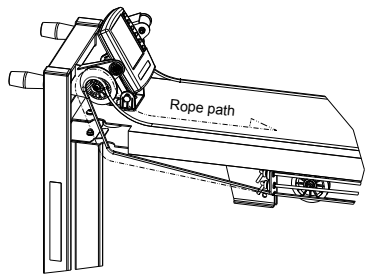

STEP 14 Tighten Upper Flywheel Mount & Lower Flywheel Bracket

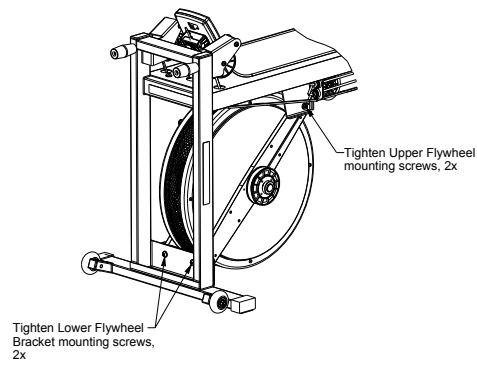

STEP 18 Wrap Rope Around Catch Pulley

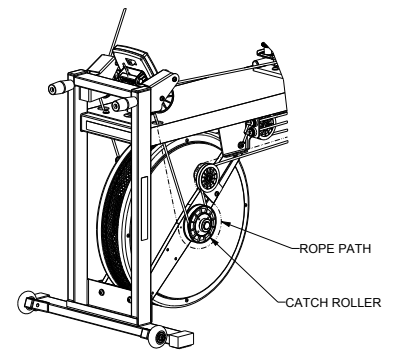

STEP 11 Fit Flywheel - Upper Mount

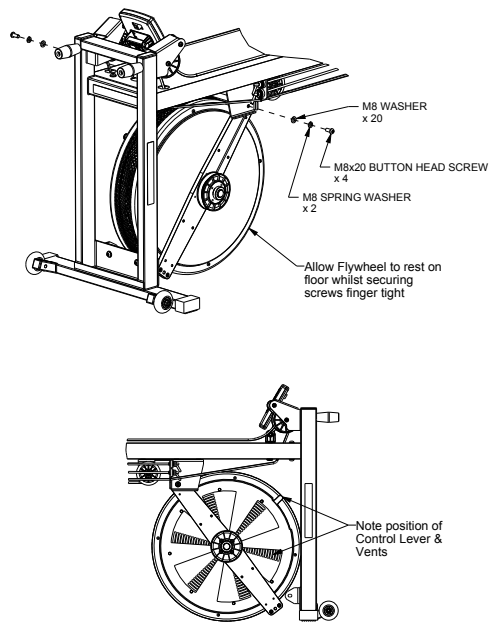

STEP 15 Fit Flywheel Pulley Assembly

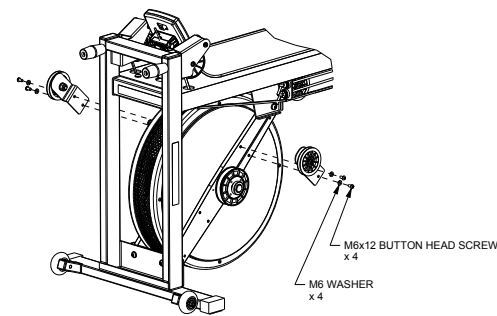

STEP 19 Fit Side Panels

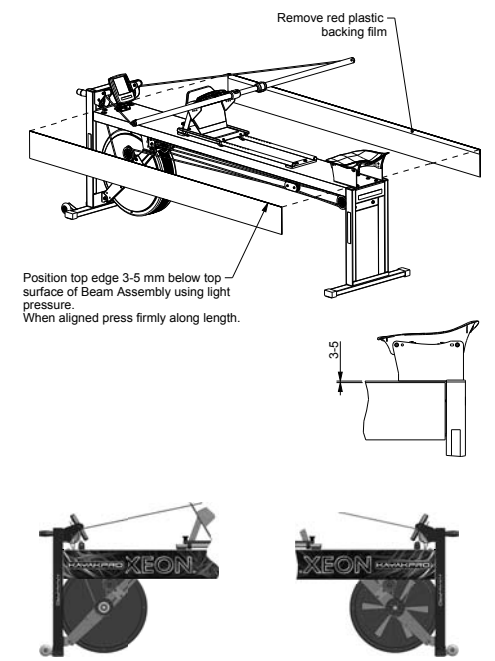

STEP 12 Thread, Secure & Connect Speed Sensor Cable

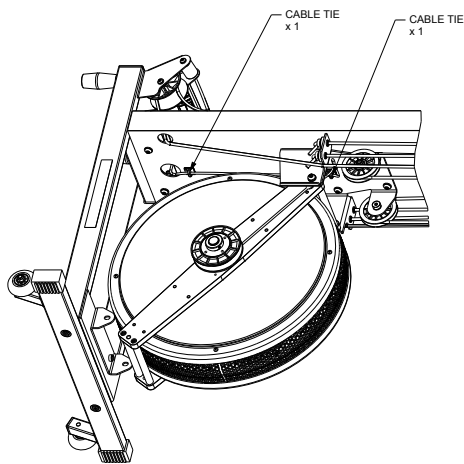

STEP 16 Assemble Paddle Shaft

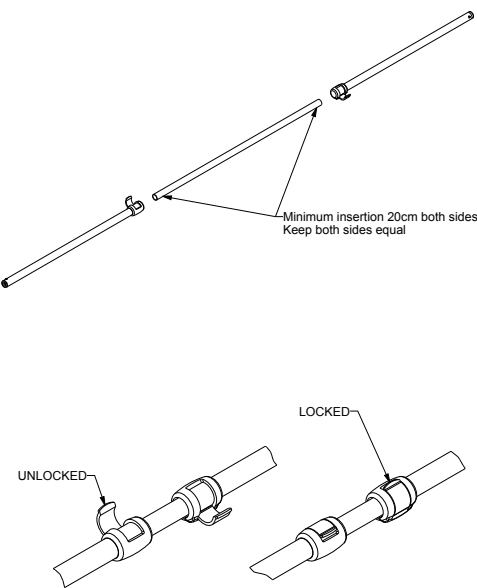

INFO Rope & Elastic Cord Layouts

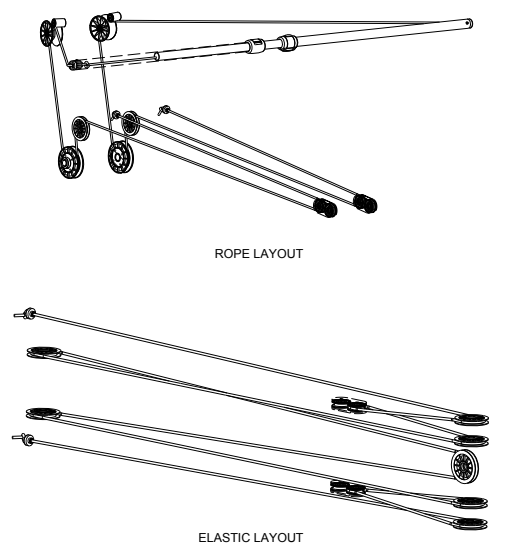

STEP 13 Fit Flywheel - Lower Mount

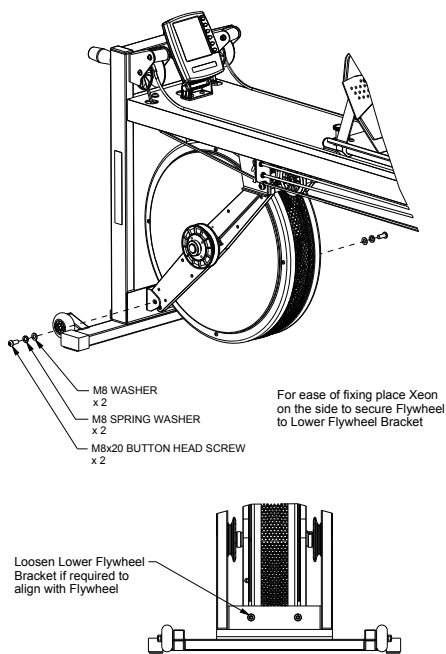

STEP 17 Connect Rope to Paddle Shaft and Recovery Adjustment

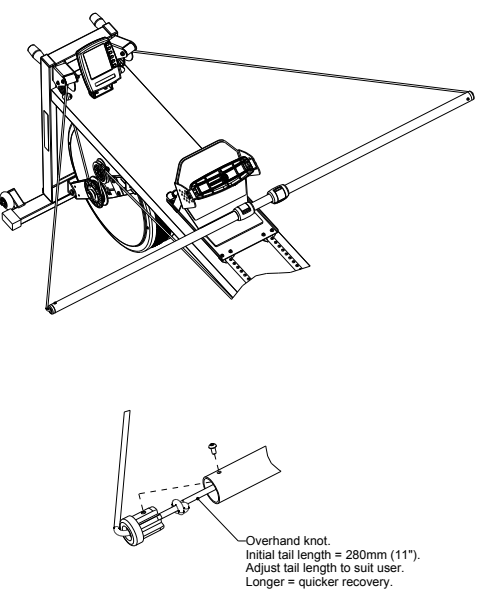

**KAYAKPRO**

KayakPro USA LLC  
1344 Van Buren St,  
Hollywood,  
FL 33019,  
USA

Email: sales@kayakpro.com  
www.kayakpro.com

